

Troubleshooting

Flowchart — Both Fans High Speed

NOTE: The both fans should run at high speed when;
— there is excessive high - side pressure in the A/C system.
— engine coolant temperature exceeds 194°F (90°C).

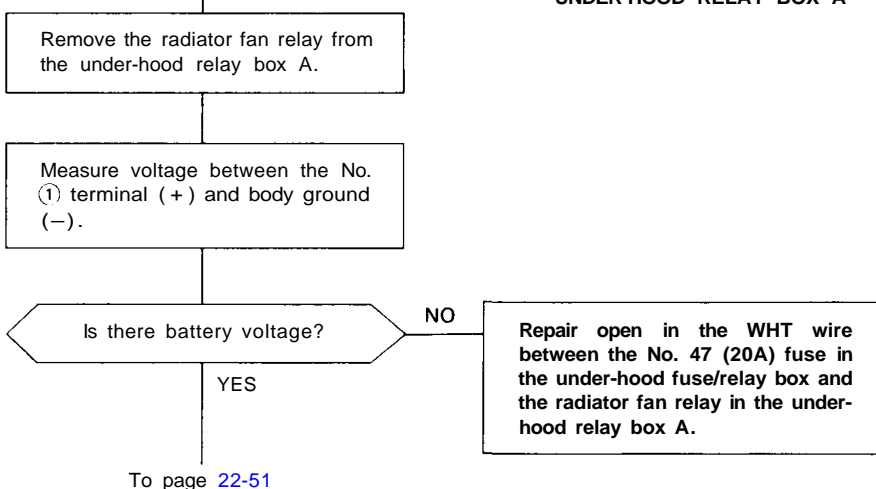

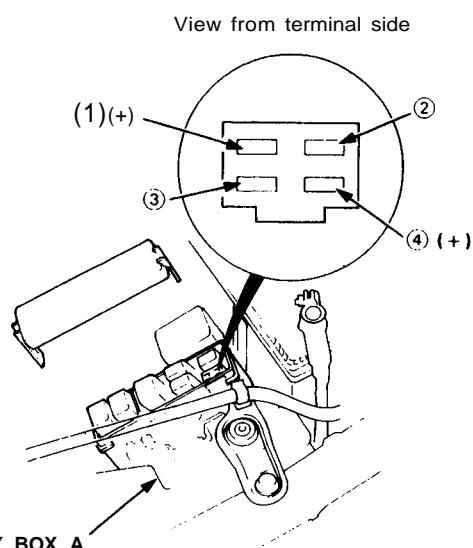
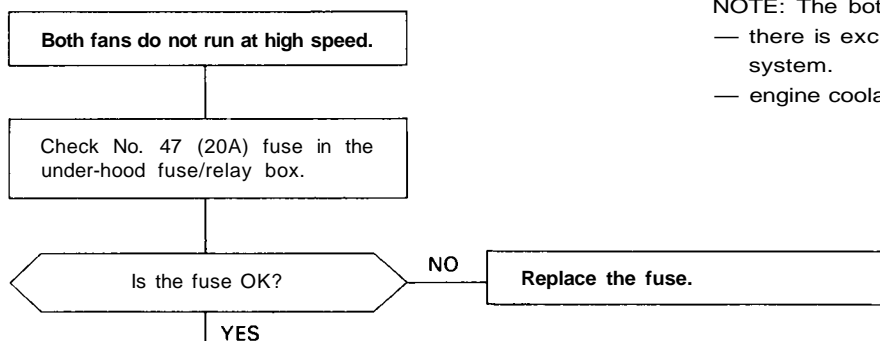

From page 22-50

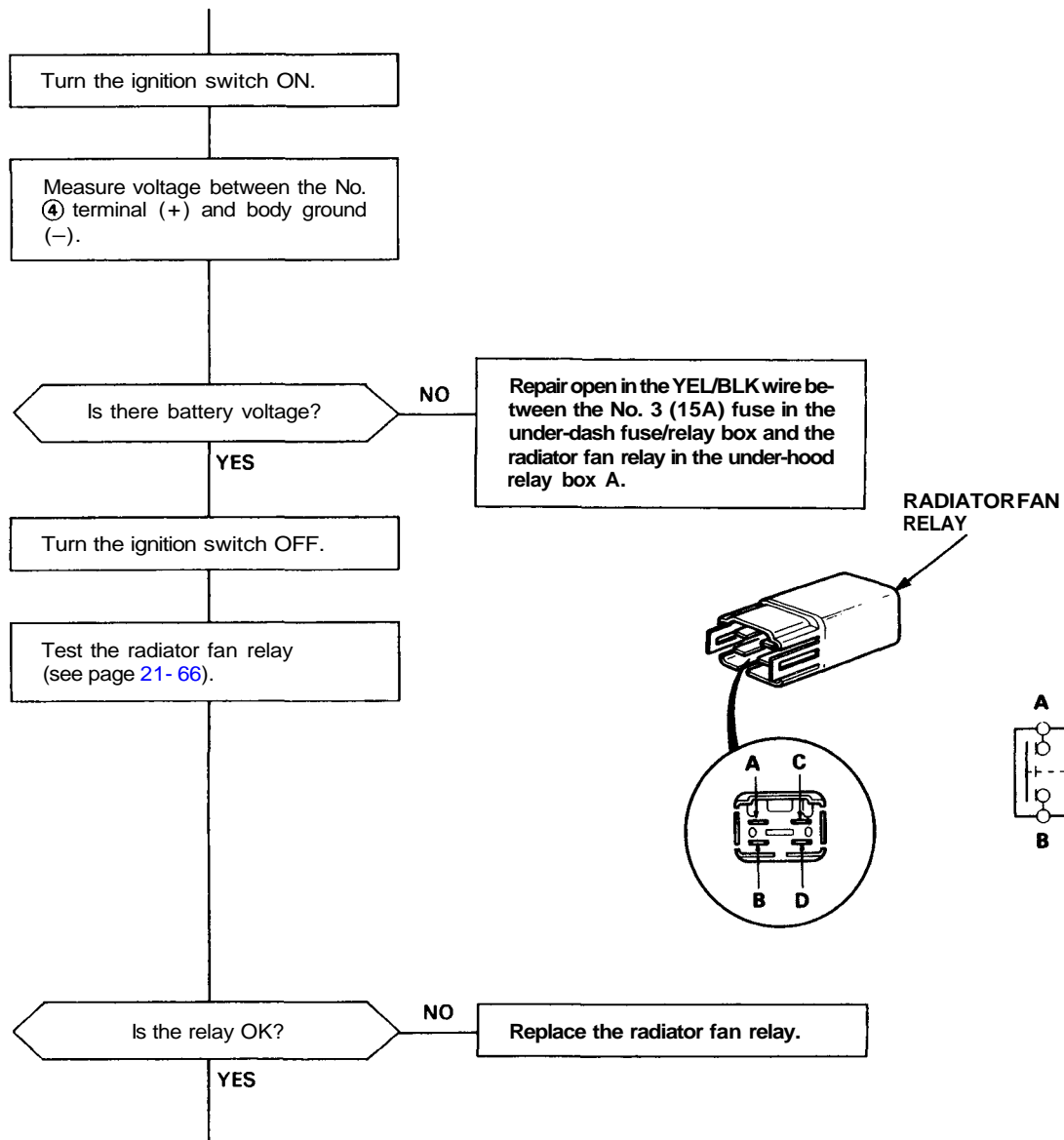

To page 22-52

(cont'd)

Troubleshooting

Flowchart — Both Fans High Speed (cont'd)

From page 22-51

Disconnect the 2P connector from the radiator fan.

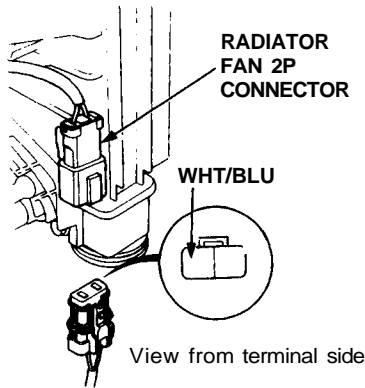

Check for continuity in the WHT/BLU wire between the No. ③ terminal of the radiator fan relay connector and the radiator fan.

Is there continuity?

NO

Repair open in the WHT/BLU wire between the radiator fan relay in the under-hood relay box A and the radiator fan.

YES

Remove the radiator fan main relay from the under-hood relay box A.

Turn the ignition switch ON.

Measure voltage between the No. ⑤ terminal (+) and body ground (-).

Is there battery voltage?

NO

Repair open in the YEL/BLK wire between the No. 3 (15A) fuse in the under-dash fuse/relay box and the radiator fan main relay in the under-hood relay box A.

YES

Turn the ignition switch OFF.

To page 22-53

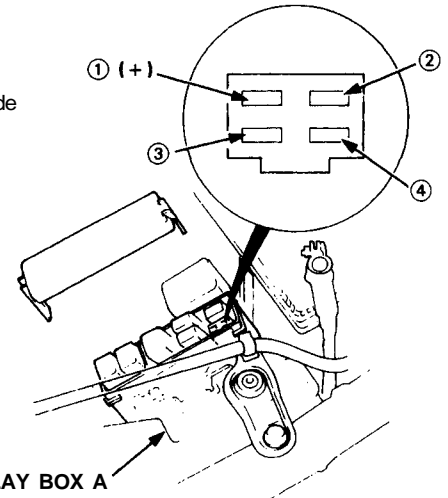

View from terminal side

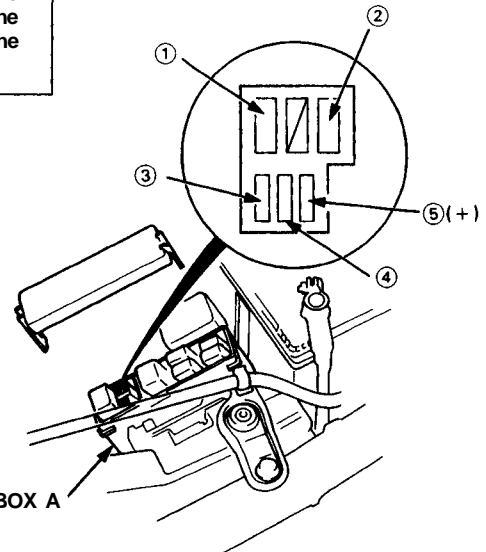

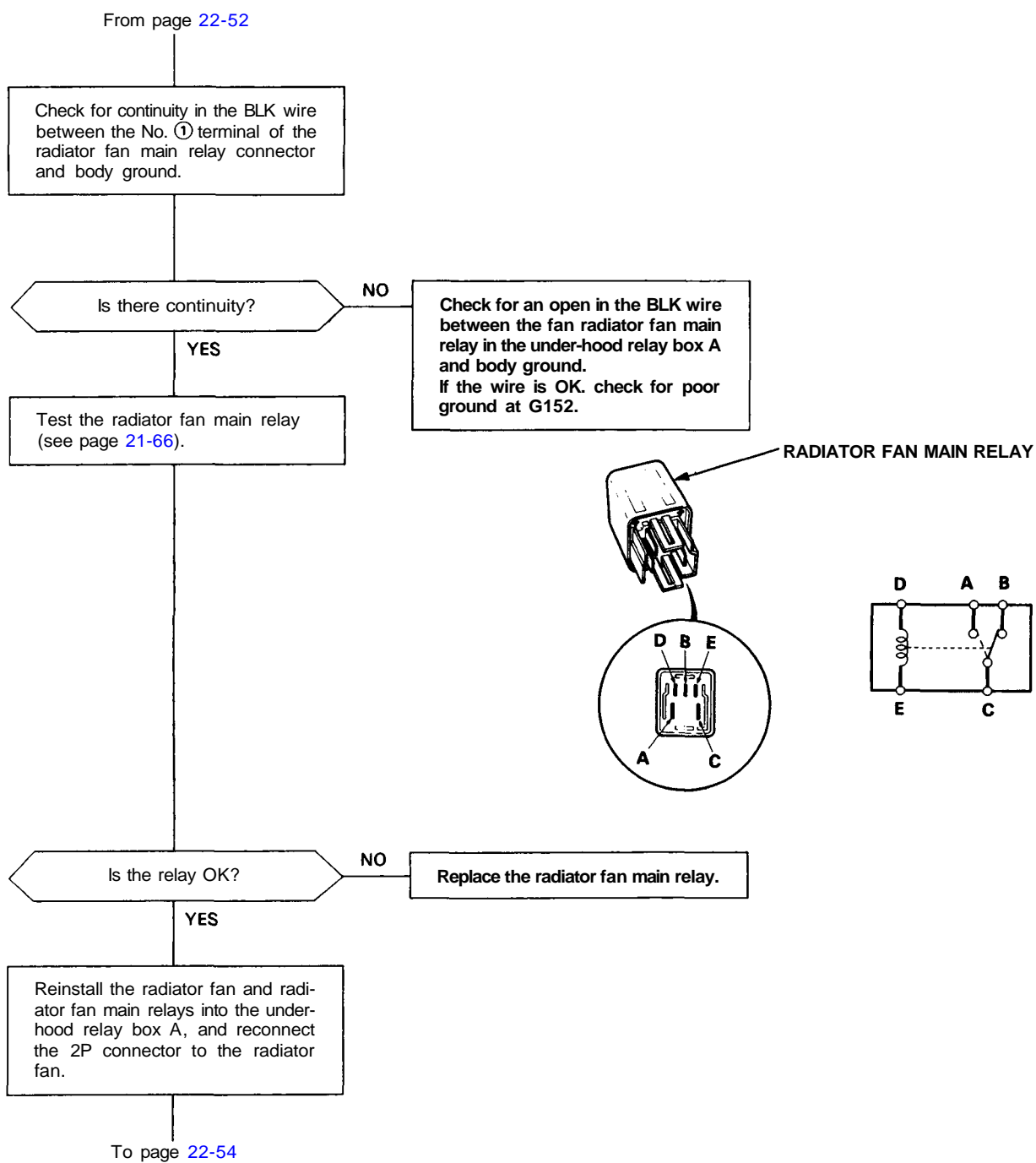

(cont'd)

Troubleshooting

Flowchart — Both Fans High Speed (cont'd)

